

Saml Sutton

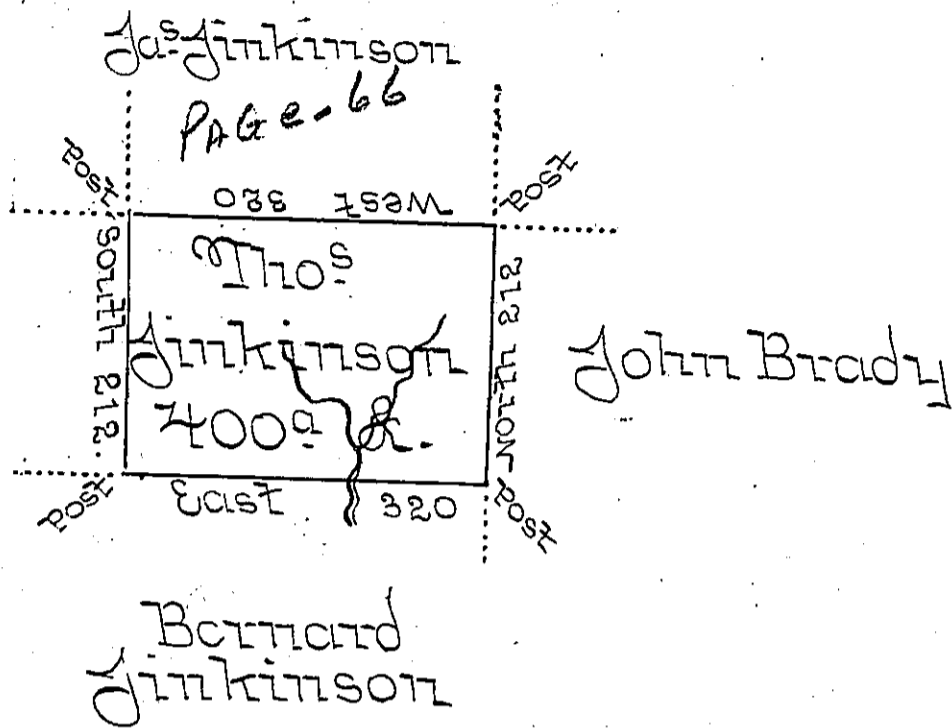

Situate on the Waters of White Deer Creek in White Deer Township Northumberland County Surveyed the 9th day of December 1794 for Thomas Jinkinson by virtue of his Warrant bearing date the Twelfth day of April 1794 Containing four hundred acres & All-OWANCE.

Jo J Wallis D.S.

To Daniel Brodhead Esq:
Surveyor General

IN TESTIMONY that the above is a copy of the original remaining on file in the Department of Internal Affairs of Pennsylvania, made conformably to an Act of Assembly approved the 16th day of February, 1833, I have hereunto set my Hand and caused the Seal of said Department to be affixed at Harrisburg, this Third day of August 1897.

James W. Pitta
Secretary of Internal Affairs.